

UBB UNDERBODY HOIST CYLINDERS

Hoist capacity is calculated assuming a free flowing load, a minimum tipping angle of 50 degrees and includes body weight.

Lifting capacity is calculated at 160 Bar (2300psi).

Maximum relief valve setting is 180 Bar (2600psi)

Always allow 20mm extension of top stage when body is in the fully lowered position to prevent the body riding on the hoist and causing damage to the hoist.

Max. working pressure 160 Bar (2300psi)

Max. relief valve pressure 180 Bar (2600psi)

Recommended hydraulic oil ISO 68.

Always fit a return line filter to the hydraulic system.

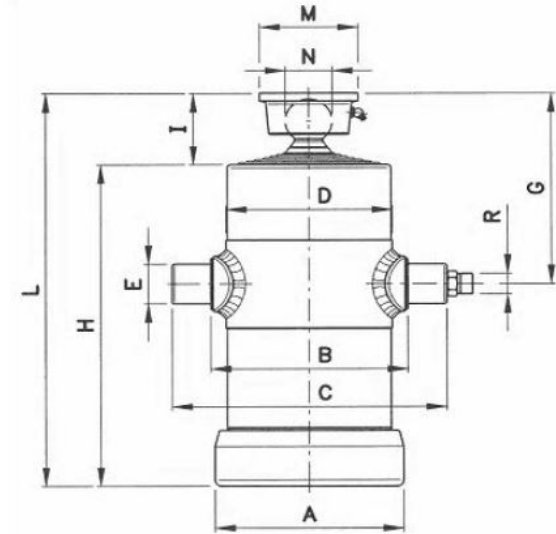

PART NUMBER	STAGES	STROKE (MM)	STAGE DIAMETER (MM)					CAPACITY IN TONNES @ 50 DEGREES				DIMENSIONS (MM)										WEIGHT KG	SWEPT VOLUME LITRES	FEET 2 REQD		
			46	61	76	91	107	NOMINAL 100 BAR	RATED 160 BAR	MAXIMUM 180 BAR	IDEAL PIVOT	A	B	C	D	E	G	H	I	L	M				N	R
UBB114-4-850	4	850	X	X	X	X	X	5	8	9	1010	130	135	220	114	35	145	290	70	360	100	45	1/2"	22	4.2	UBFM-35
UBB127-5-1050	5	1050	X	X	X	X	X	5	8	9	1250	145	150	230	127	40	145	290	70	360	100	45	1/2"	26	6.5	UBFM-40
UBB127-5-1250	5	1250	X	X	X	X	X	5	8	9	1490	145	150	230	127	40	145	331	70	401	100	45	1/2"	29	7.6	UBFM-40
UBB127-5-1500	5	1500	X	X	X	X	X	5	8	9	1785	145	150	230	127	40	145	381	70	451	100	45	1/2"	33	9	UBFM-40

CYLINDER FEET DIMENSIONS (MM)									
PART NUMBER	A	B	C	D	E	F	G	H	WEIGHT KG
UBFM-35	130	95	12	35.5	30	13	40	56	0.9
UBFM-40	140	108	15	40.5	33	15	45	66	1.2

